



INSTALLATION INSTRUCTIONS

DCT470 EVO X SUMP KIT

DMS-00-0047 REVISION 002

06 JANUARY 2023

PREPARED BY: JAN PISL
DATE: 25JUL2022

RELEASED BY: 
DATE: 06JAN2023

REVISION UPDATE NOTES:

The following table indicates the changes we have made in either the disassembly or assembly of the product you have received. All changes are indicated by a revision bar in the margin.

If you have any questions email us at technical@dodsonmotorsport.com

Revision	Date	Description
REV.002	06JAN2023	<ul style="list-style-type: none">- Revised formatting.- Added missing photos and rewrote affected steps.
REV.001	13SEP2021	<ul style="list-style-type: none">- Converted to new format.

DCT470 EVO X SUMP KIT CONTENTS

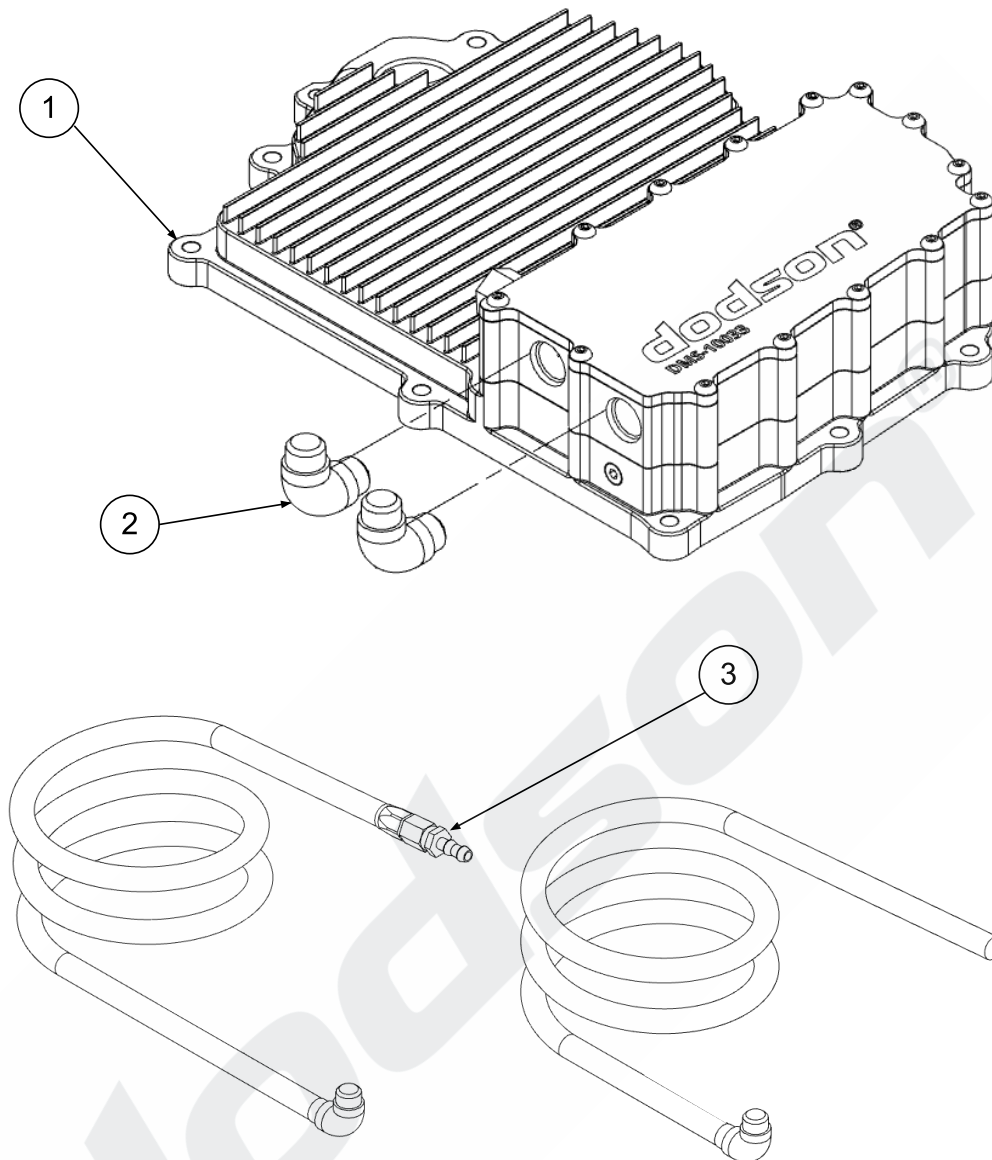

Item Number	Part Name	DMS Code	Qty
1	Transmission Sump	DMS-10033	1
2	90° Swivel Hose-end Fitting	DMS-0605*	2
3	Sump Hose Kit	DMS-0634**	1

* LHD option, without hose kit

**RHD option with hose kit

NOTE

The Dodson DCT470 EVO X Transmission Sump has a provision for an optional temperature sensor which can be fitted in place of the 1/8" NPT plug on the heat exchanger housing.

DCT470 EVO X SUMP INSTALLATION INSTRUCTIONS**STEP 1**

Remove the plastic undertray and side guards. And drain the cooling system.

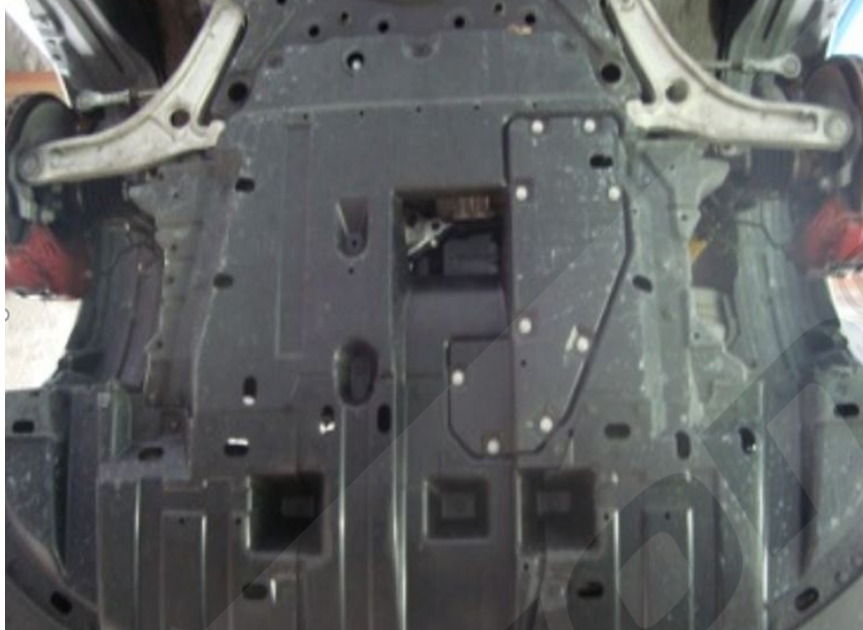
**STEP 2**

Remove the three oil drain plugs and drain transmission fluid.

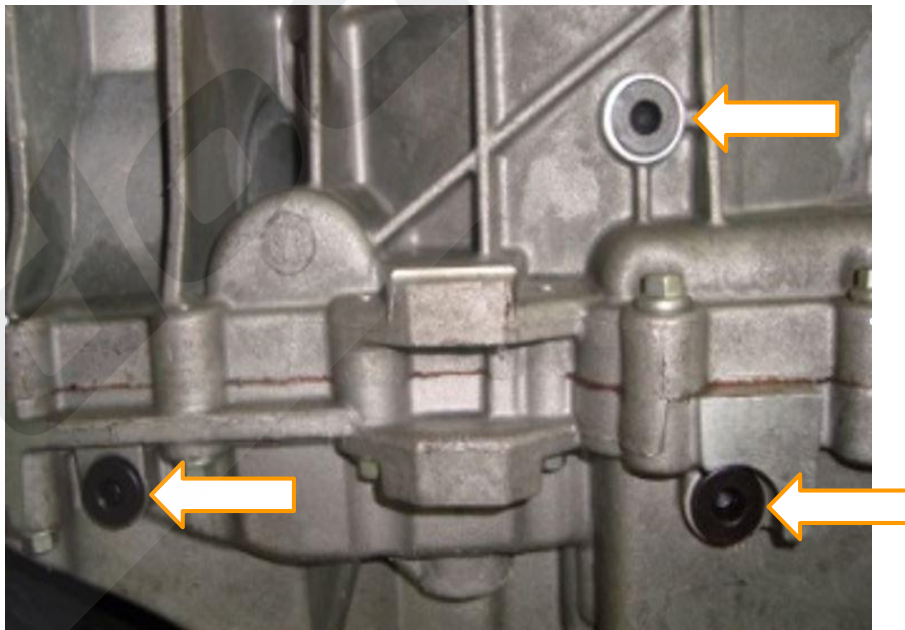

STEP 3

Remove the 11x sump pan bolts, unplug the wiring harness and remove the pan.

NOTE: Loosening/removing the intercooler pipe and the bottom radiator hose may be necessary for easier access.



STEP 4

Install the Dodson sump (**DMS-10033**) using OEM bolts and gasket.



HEAT EXCHANGER PLUMBING

Please note that the following instructions are for RHD models for which the optional hose kit is designed. If fitting on a LHD vehicle, you will need to fabricate custom hoses to suit the different heater hose length/location using the supplied fittings for the heat exchanger.

STEP 1

Disconnect the MAF sensor, unbolt and remove the air box.



STEP 2

Locate the engine block-to-heater outlet hose and disconnect it.

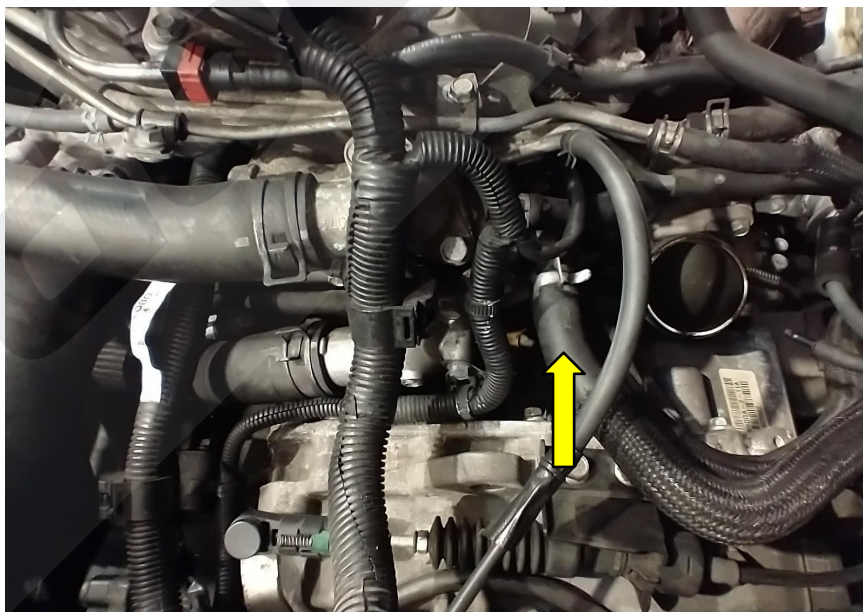

STEP 3

Route hoses supplied with the kit from the sump to the heater outlet on the block. Take care to secure the hoses away from moving parts and sharp edges to avoid damaging the hoses.

Loosely attach the 90° swivel fittings to the Dodson sump heat exchanger for the time being.

STEP 4

- Connect the hose without a fitting to the outlet pipe on the engine and secure it with a suitable hose clamp.
- Connect the hose with the hose barb fitting to the existing heater hose and secure it with a suitable hose clamp.

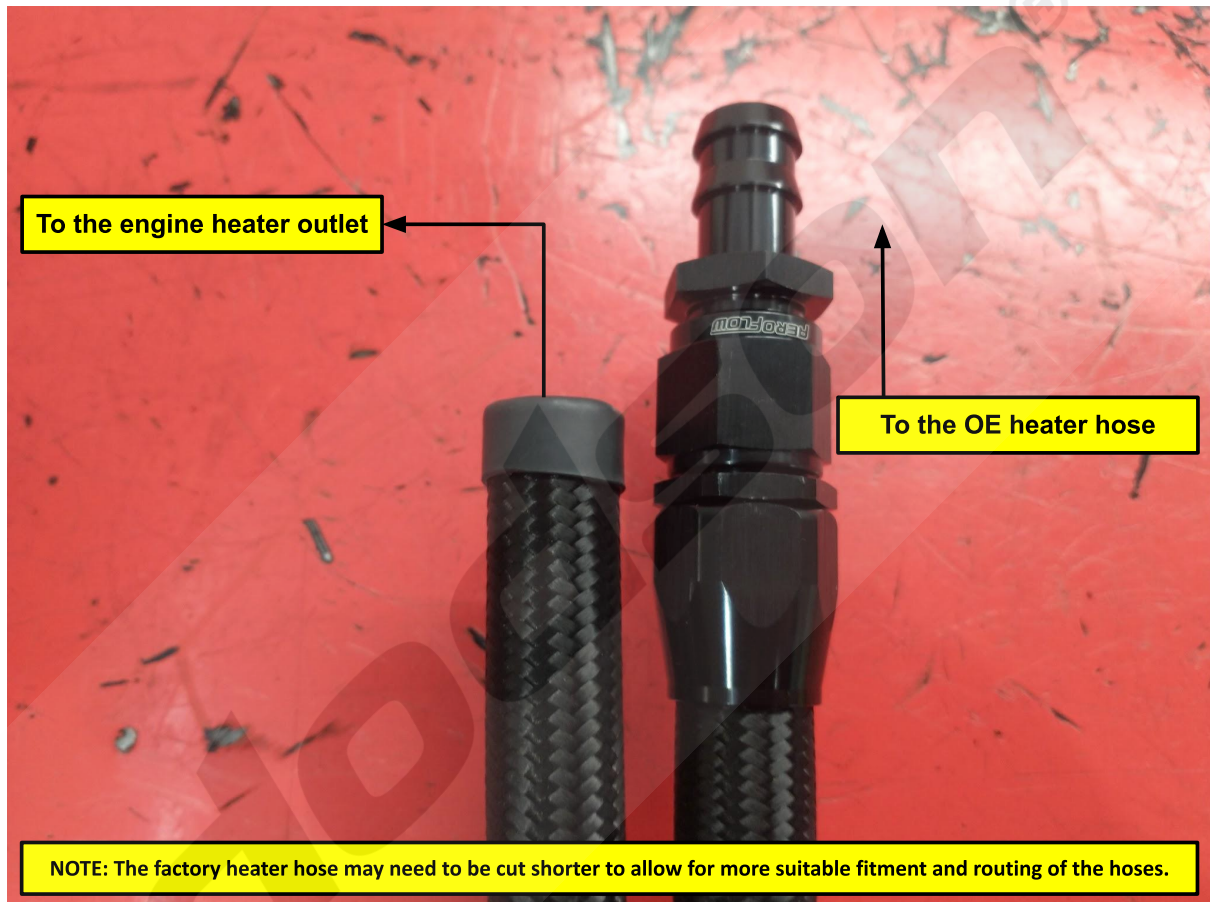

STEP 5

Once happy with the final routing and mounting of the hoses, tighten the 90° swivel fittings on the heat exchanger.

STEP 6

Refill and bleed the cooling system. Fill the transmission with 7.5 litres of Dodson transmission fluid and reassemble the vehicle.

If you have any questions email us at technical@dodsonmotorsport.com