

dodson[®]

INSTALLATION INSTRUCTIONS

GR6 FWD OUTPUT BEARING UPGRADE

DMS-00-0042 REV 001

21 JUNE 2022

**PREPARED BY: JAN PISL
DATE: 21 JUN 2022**

**RELEASED BY: 
DATE: 21 JUN 2022**

REVISION UPDATE NOTES:

The following table indicates the changes we have made in either the disassembly or assembly of the product you have received. All changes are indicated by a revision bar in the margin.

If you have any questions email us at technical@dodsonmotorsport.com

Revision	Date	Description
REV.001	21JUN22	- Converted to new format.

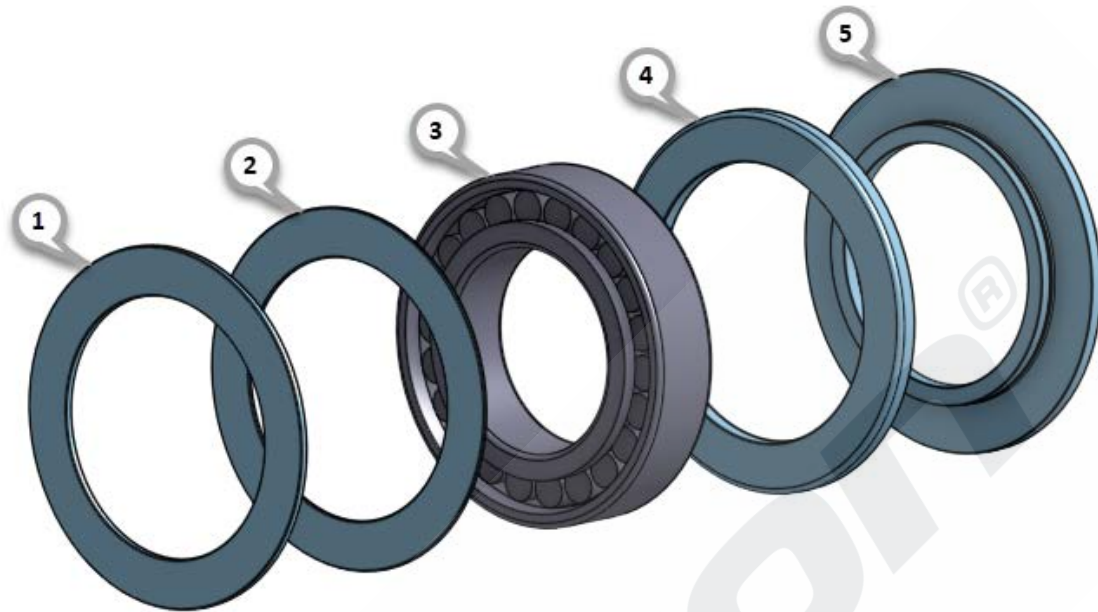
**GR6 FWD OUTPUT BEARING UPGRADE KIT CONTENTS
(DMS-7910)**

Item Number	Part Name	DMS Code	Qty
1	Thrust Shim 1.6mm	DMS-0062	1
2	Thrust Shim 0.8mm	DMS-0061	1
3	Upgraded Bearing	DMS-1436	1
4	Torrington Bearing	DMS-1437	1
5	FWD Upgrade Spacer	DMS-0060	1

BY OPENING AND USING THIS DOCUMENT YOU AGREE TO ABIDE BY THE FOLLOWING CONDITIONS. INFORMATION CONTAINED IN PART OR IN WHOLE REMAINS WITH DODSON MOTORSPORT. DODSON MOTORSPORT ACCEPTS NO RESPONSIBILITY FOR ANY REASON WHATSOEVER. DO NOT COPY / REPRODUCE IN ANY FORM OR MAKE PUBLIC WITHOUT THE PERMISSION OF DODSON MOTORSPORT.

GR6 FWD OUTPUT BEARING UPGRADE KIT INSTALLATION INSTRUCTIONS

DISASSEMBLY & ASSEMBLY

STEP 1

Remove transmission and split clutch housing from the transmission.

STEP 2

Remove the electromagnet plug and wiring loom from the housing.

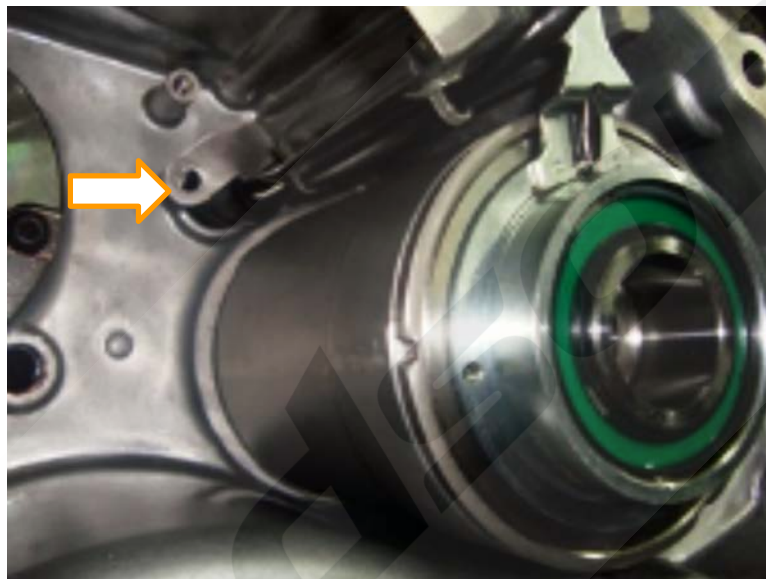

STEP 3

Using the tool from the FWD tool kit, hold the FWD output flange and remove the nut.



BY OPENING AND USING THIS DOCUMENT YOU AGREE TO ABIDE BY THE FOLLOWING CONDITIONS. INFORMATION CONTAINED IN PART OR IN WHOLE REMAINS WITH DODSON MOTORSPORT. DODSON MOTORSPORT ACCEPTS NO RESPONSIBILITY FOR ANY REASON WHATSOEVER. DO NOT COPY / REPRODUCE IN ANY FORM OR MAKE PUBLIC WITHOUT THE PERMISSION OF DODSON MOTORSPORT.

STEP 4

Remove the FWD clutch unit from the housing. You may need to use a soft hammer for assistance.



STEP 5

Place the unit with the stub facing up and remove the four bolts to remove the stub from the housing.



STEP 6

Pull the bearing off the stub and then machine the flange as per the following instructions.

Standard Drive Yoke

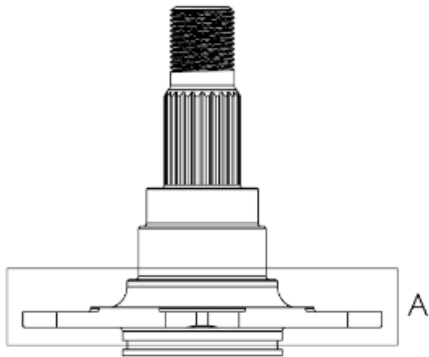

Machined Drive Yoke

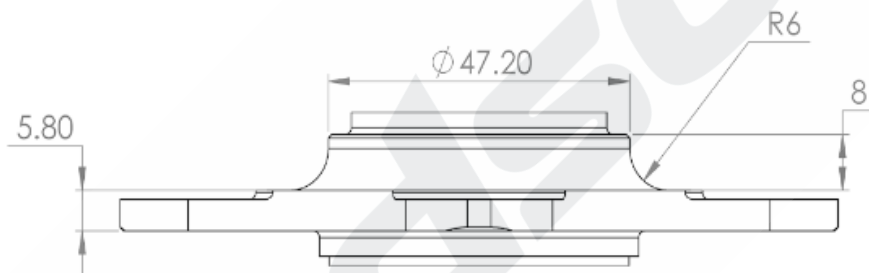
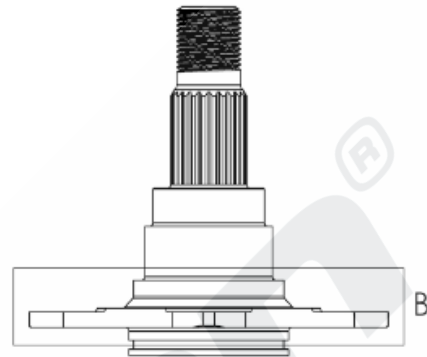

DETAIL A - Standard Drive Yoke

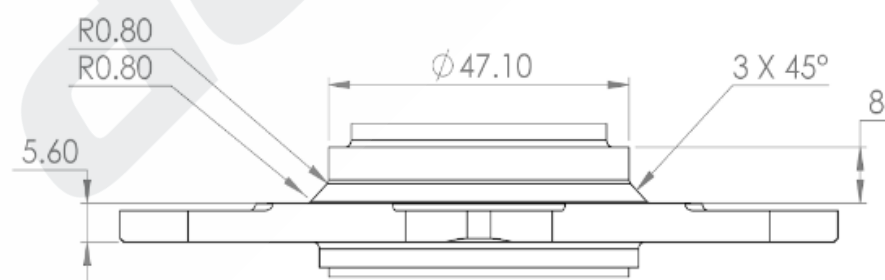

DETAIL B - Machined Drive Yoke

STEP 7

Heat and press the upgrade spacer on the stub shaft.



STEP 8

Heat and press the inner bearing sleeve on the stub.



STEP 9

Clip-on the Torrington bearing by hand.



STEP 10

Bolt the stub assembly back to the FWD clutch housing. Install the desired end float shim in the clutch housing. **The end float should be 0.4-0.8mm.**



STEP 11

Fit the FWD unit back in the clutch housing, fit the flange and nut and fit the wiring loom and plug.



ASSEMBLED UPGRADE KIT FOR REFERENCE



If you have any questions email us at technical@dodsonmotorsport.com

BY OPENING AND USING THIS DOCUMENT YOU AGREE TO ABIDE BY THE FOLLOWING CONDITIONS. INFORMATION CONTAINED IN PART OR IN WHOLE REMAINS WITH DODSON MOTORSPORT. DODSON MOTORSPORT ACCEPTS NO RESPONSIBILITY FOR ANY REASON WHATSOEVER. DO NOT COPY / REPRODUCE IN ANY FORM OR MAKE PUBLIC WITHOUT THE PERMISSION OF DODSON MOTORSPORT.