



INSTALLATION INSTRUCTIONS

GR6 DRAG SUMP

DMS-00-0054 REV 003

15 FEBRUARY 2023

GR6 DRAG TRANSMISSION SUMP KIT CONTENTS (DMS-7173)

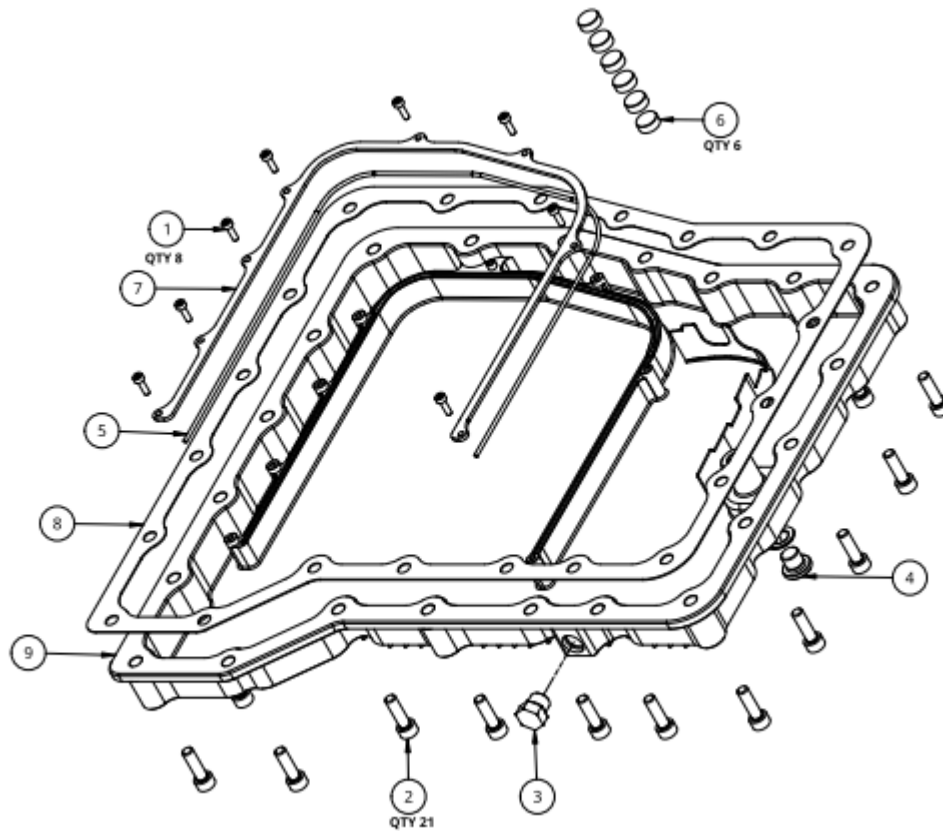

Item Number	Part Name	DMS Code	Qty
1	M3 Cap Bolt	DMS-0013	8
2	M6 Cap Bolt	DMS-0022	21
3	Port Plug 4AN	DMS-0608	1
4	Sump Plug	DMS-0609	1
5	Filter Retention Seal	DMS-1900	1
6	Magnet	DMS-6119	6
7	Filter Retention Bracket	DMS-6167	1
8	Transmission Pan Gasket	DMS-8380	1
9	Transmission Drag Sump	DMS-10001	1

REVISION UPDATE NOTES:

The following table indicates the changes made in this document since the previous revision. All changes will be indicated by a revision bar in the margin.

If you have any questions email us at technical@dodsonmotorsport.com

Revision	Date	Description
REV.003	8NOV2022	- Updated to new format - Added updated BOM
REV.002	20SEP2021	- Added BOM and adjusted formatting
REV.001	15SEP2021	- Update to new format

GR6 DRAG SUMP INSTALLATION INSTRUCTIONS PREPARATION

STEP 1

Place the OEM pan filter in the cradle, make sure the o-ring is firmly in place.

Note: New filters are available from Dodson, part number: DMS-2811.

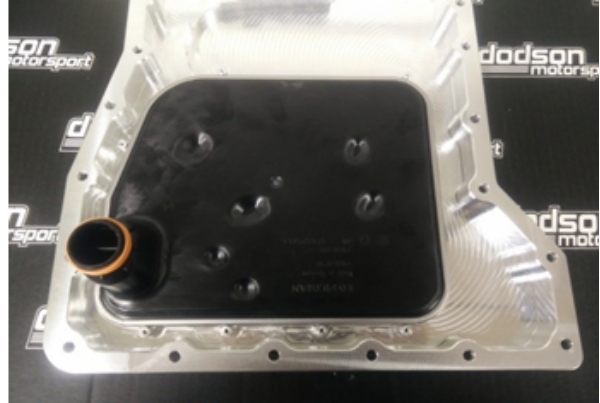
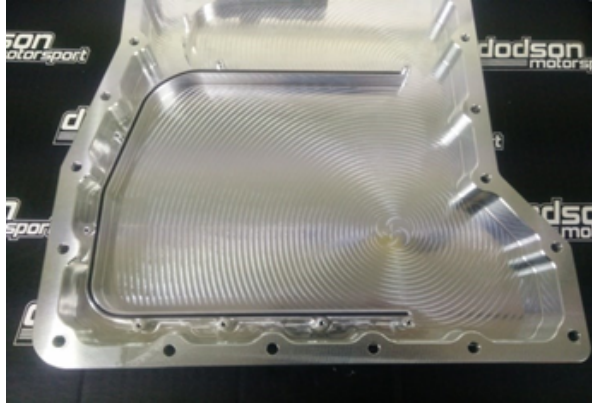

STEP 2

Secure filter with retainer and bolts supplied.

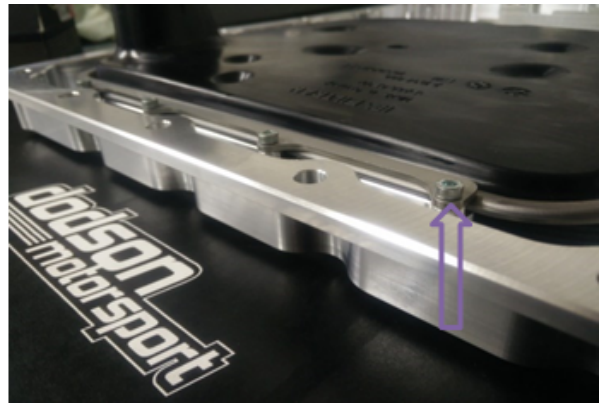
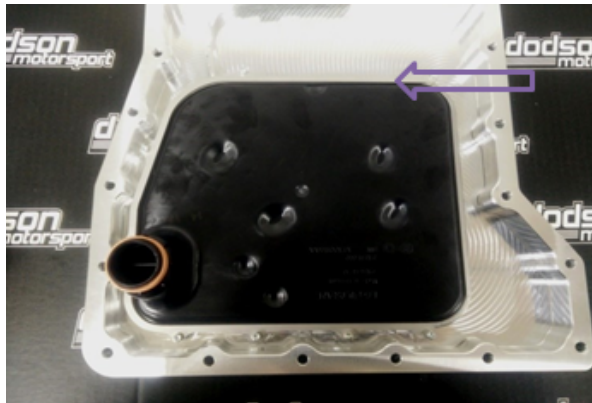

INSTALLATION

FIRST WE NEED TO ADJUST THE VALVE BODY LOOM POSITION TO CLEAR THE PAN FILTER CRADLE INLET

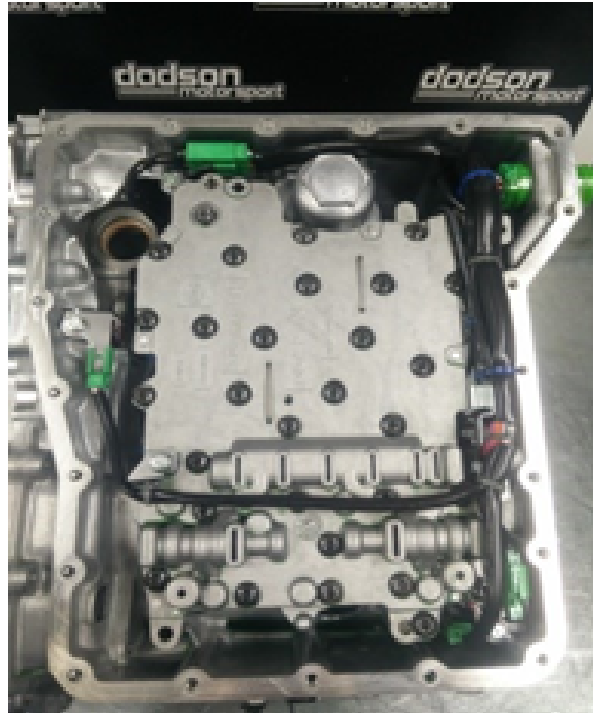

STEP 1

Unbolt and remove this bracket and remove the tie on the loom.



STEP 2

Carefully tuck the loom beside the valve body.



STEP 3

Secure the temperature sensor to the clutch valve body loom using a cable tie.



STEP 4

Tuck the loom alongside the valve body and bend this bracket over it.

Note: Make sure the loom doesn't get pinched.

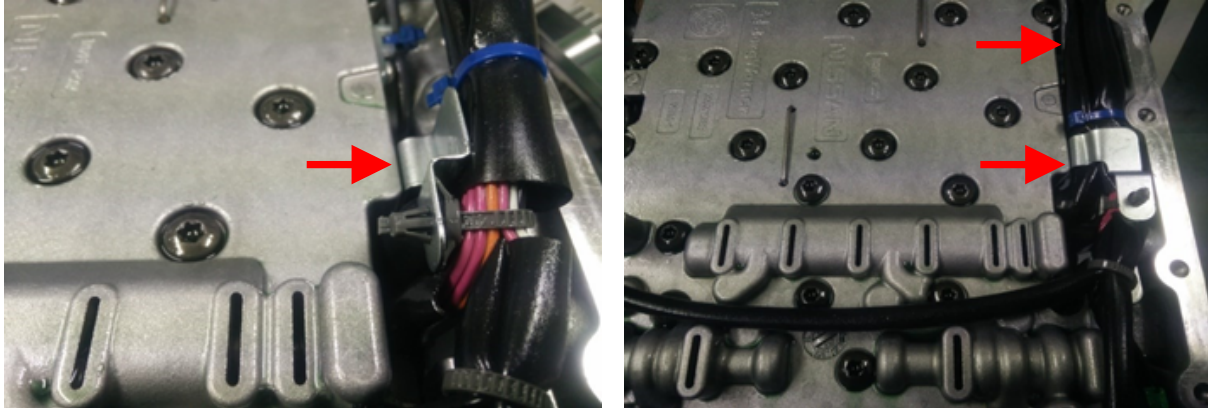

STEP 5

Remove this loom tie.

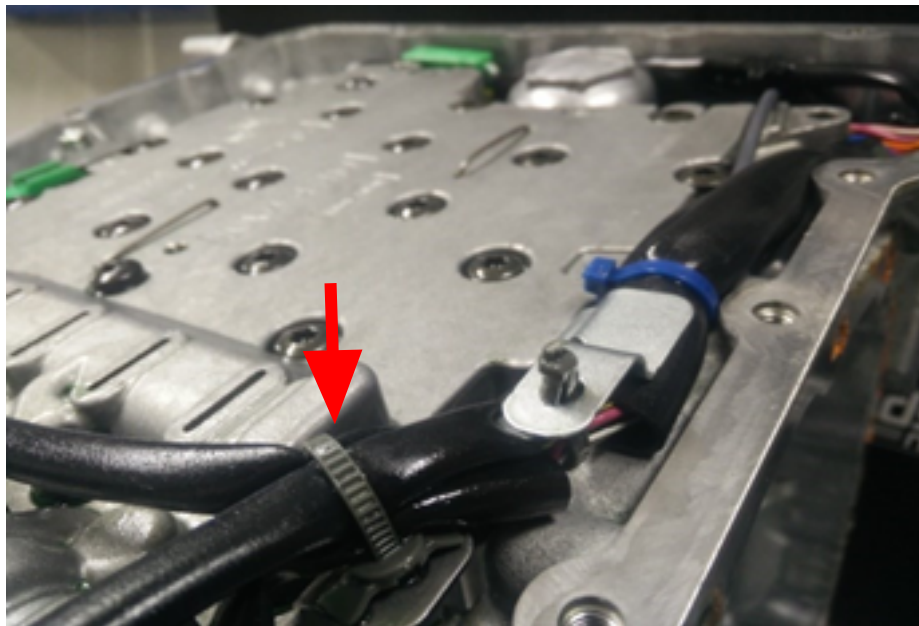

STEP 6

Route the shaft speed sensor wires under the bracket and cable tie.

Note: FWD speed sensor loom goes over the bracket.

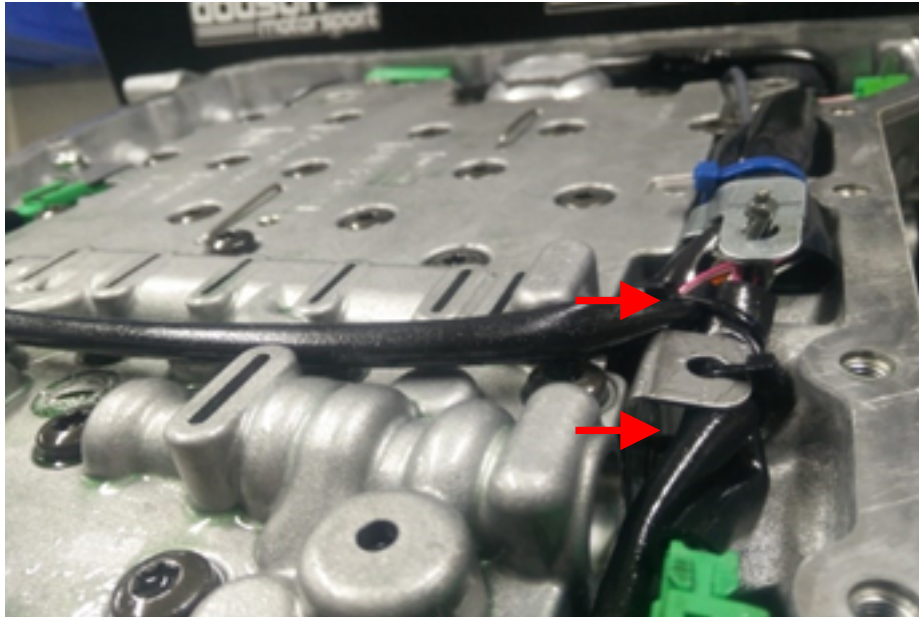

STEP 7

Remove the tie and bracket on the fwd output speed sensor loom.



STEP 8

Add additional cable ties to compact the loom.



STEP 9

Bolt sump pan to transmission using bolts and gasket supplied.

Ensure the filter lines up with the oil pump correctly and that no loom gets pinched.



STEP 10

Fit factory oil level height tube. (NOTE: OE sump plug can be reused if preferred)



If you have any questions email us at technical@dodsonmotorsport.com