



# INSTALLATION INSTRUCTIONS

C8 SUMP UPGRADE

**DMS-00-0006 REVISION 002**

05 JANUARY 2022

PREPARED BY: ALEXANDER FAULCONBRIDGE

DATE: 05 JAN 2022

RELEASED BY:

A handwritten signature in black ink, appearing to read "AFD", with a horizontal line extending to the right.

DATE: 07 JAN 2022

**SUMP UPGRADE KIT CONTENTS**

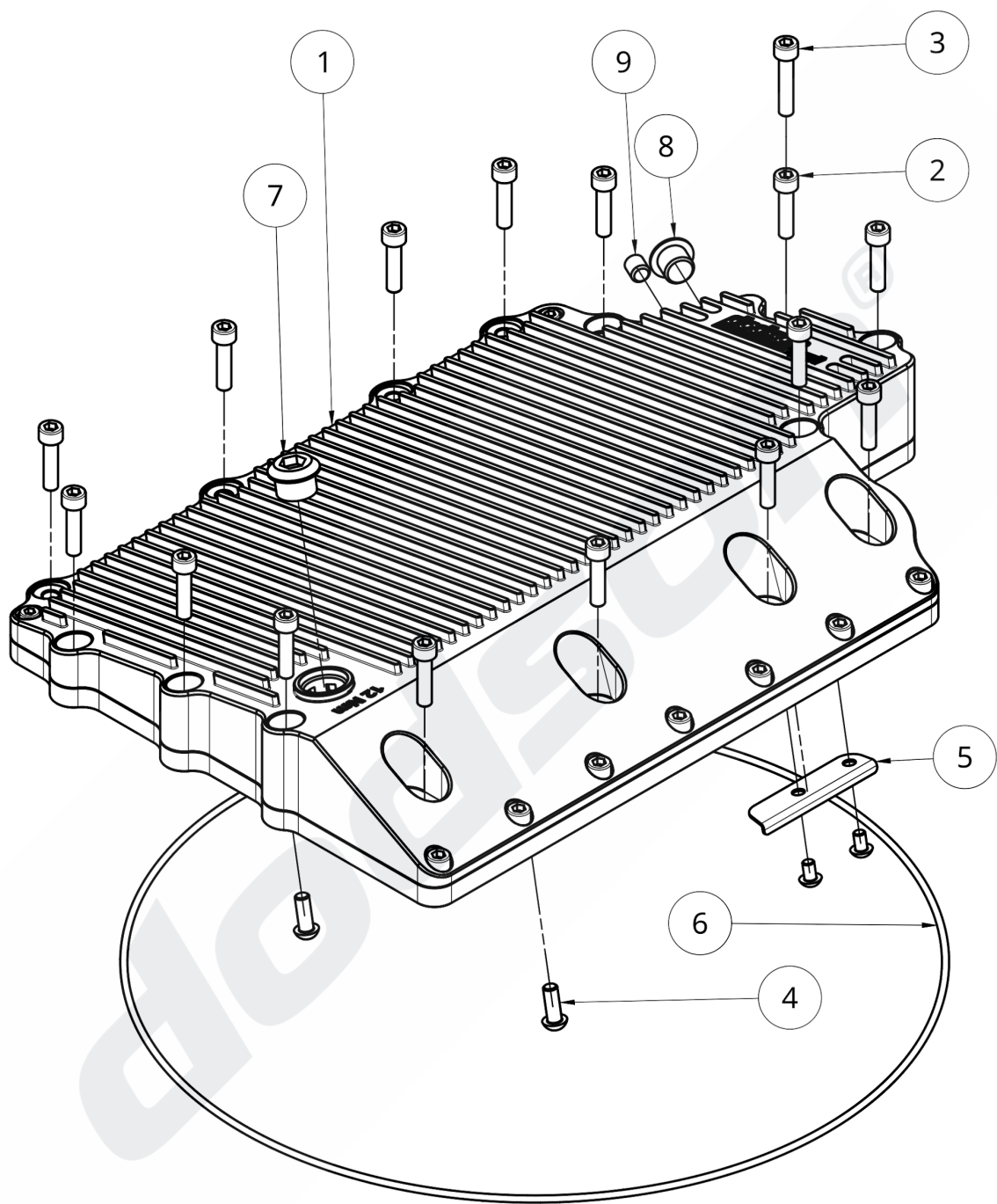

Part Number	Part Name	DMS Code	Qty
-------------	-----------	----------	-----

---

1	Sump Pan Assembly	DMS-7200	1
2	Mounting Bolts	DMS-0023	15
3	Mounting Bolt Long	DMS-0140	1
4	Filter Bolts	DMS-0141	2
5	Filter Hold Down Plate	DMS-6205	1
6	Sump O-Ring	DMS-2002	1
7	Drain Plug	DMS-0607	1
8	External Cooler Plug	DMS-0638	1
9	Temperature Sensor Plug	DMS-0612	1

**NOTE:**

The C8 Billet Sump Upgrade comes pre-assembled. The installer needs only to mount the filter to the sump pan and fit to the vehicle.

**REVISION UPDATE NOTES:**

The following table indicates the changes we have made in either the disassembly or assembly of the product you have received. All changes are indicated by a revision bar in the margin.

If you have any questions email us at [technical@dodsonmotorsport.com](mailto:technical@dodsonmotorsport.com)

<b>Revision</b>	<b>Date</b>	<b>Description</b>
REV.001	15/09/21	Updated to new format
REV.002	23/12/21	Changed step numbering, modified formatting

**IMPORTANT NOTES:**

Any important steps that are often missed will be highlighted in Yellow.



## **INSTALLATION INSTRUCTIONS**

### **PREPARATION**

#### **STEP 1**

Remove the vehicle undertrays to allow access to the transmission sump pan. Drain transmission oil and remove the sump pan.

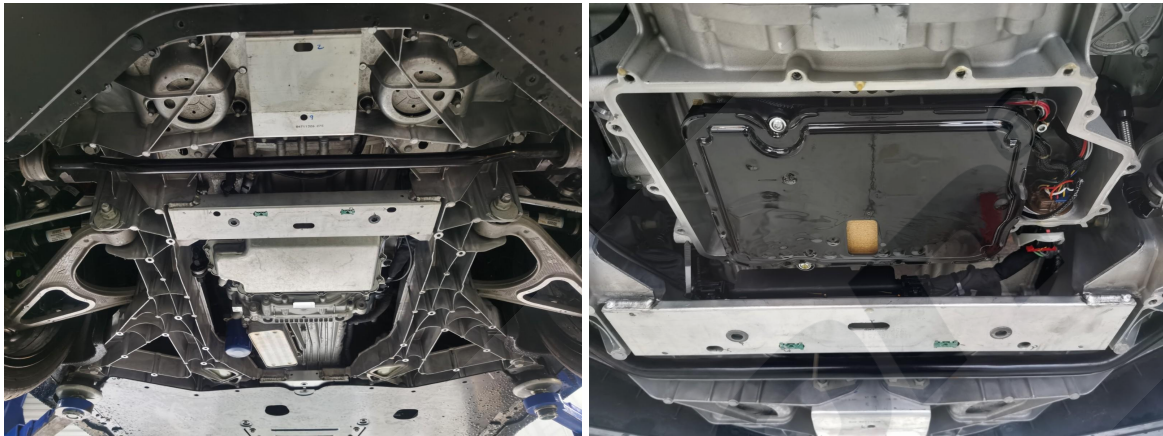

#### **STEP 2**

Remove the four bolts mounting the transmission pan filter to the valve body, and remove the filter.

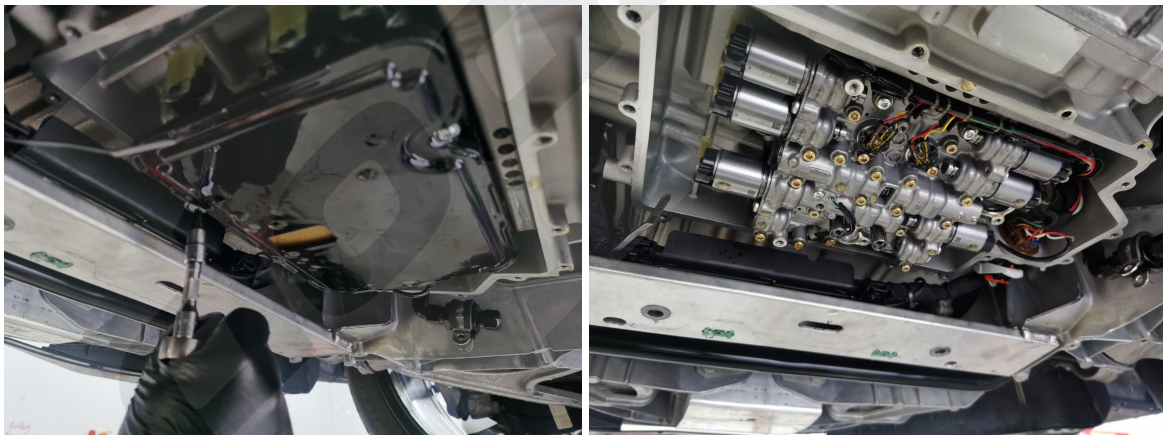

**STEP 3**

Unplug the wiring loom from the connector on the side of the transmission to allow space for the installation of the billet sump pan.

**FILTER INSTALLATION****STEP 4**

Remove the two filter mounting bolts and the bolts holding down the filter hold down plate (the magnets may come out as well - ensure these are replaced during the filter installation process).





**STEP 5**

Place the filter removed from the vehicle onto the ridge in the billet sump pan, and replace the filter mounting bolts as shown.

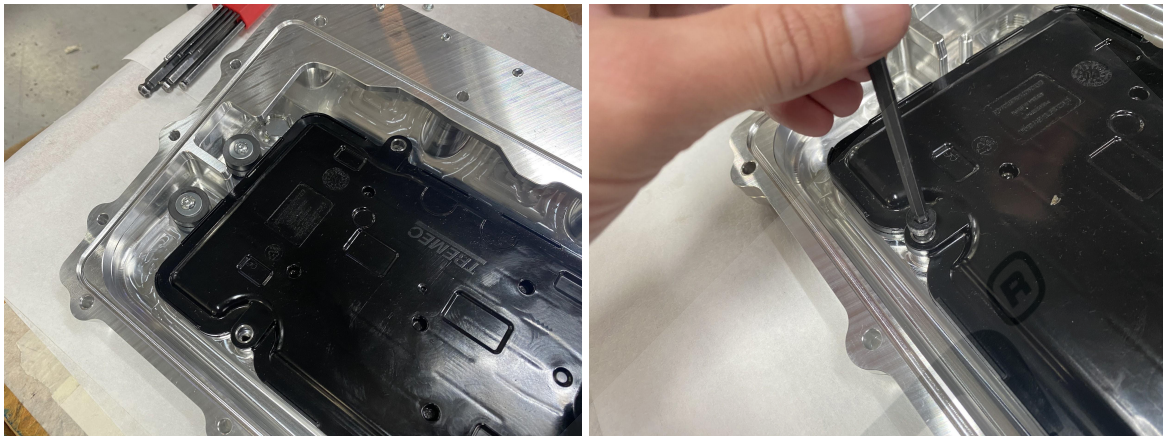
**STEP 6**

Replace the filter hold down plate and tighten to clamp down the end of the filter. Ensure that the magnets and washers are replaced as they were installed before.

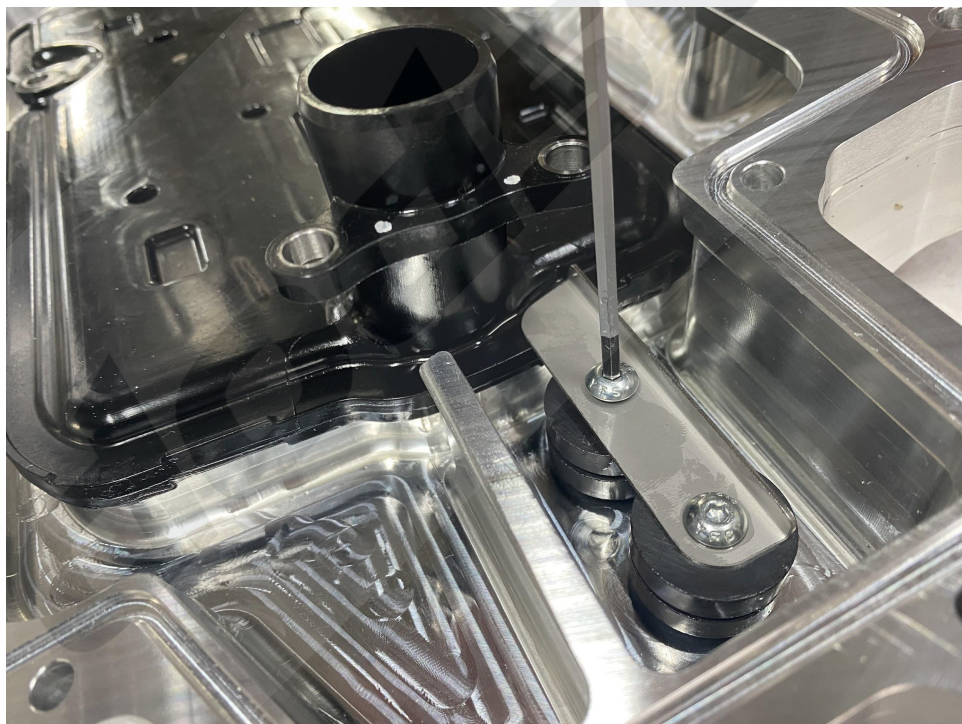

**NOTE: The filter hold down plate will bend slightly as the bolts are tightened - this is normal.**

**|STEP 7**

Before installing the sump onto the transmission, ensure that the o-ring is properly seated into the seal groove.

**SUMP PAN INSTALLATION**

**IMPORTANT:** Installation of the sump pan requires lifting the rear of the transmission free from the subframe. Please follow these instructions carefully.

**|STEP 8**

Remove the six nuts (three on each side) securing the rear transmission mounts to the subframe.

**|STEP 9**



Raise the rear of the transmission using a wooden block to prevent any damage to the transmission housing. Raise slowly until the clearance between the transmission and the subframe cross-member is just enough to get the sump pan into position as shown below.



**STEP 10**

Secure the sump in place using the 15 included M6x25mm cap screws.

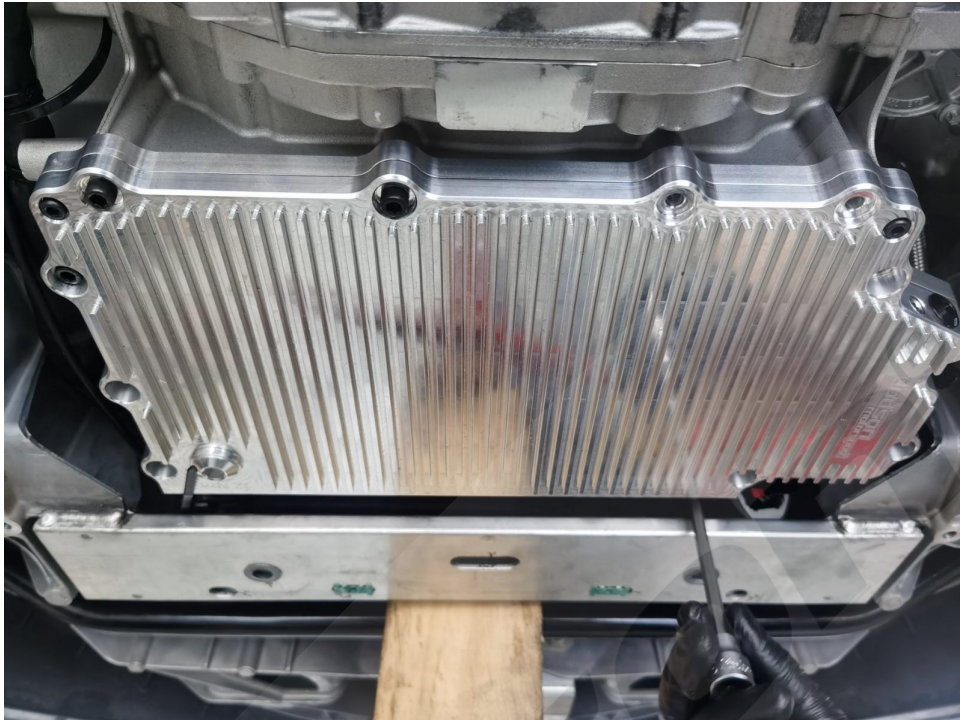

**Note: A ball end hex key will be required to install and torque the four mounting bolts along the rear edge of the sump, as shown below.**

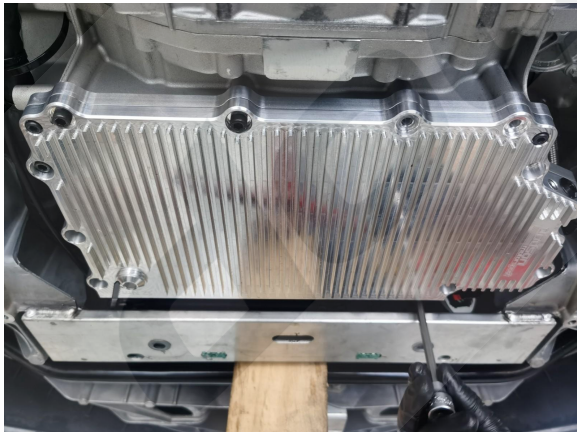

**STEP 11**

Torque all mounting bolts to **7.5 Nm**.



**NOTE:** A longer mounting bolt is included in the kit, to be used if the **Dodson Motorsport Filler Kit** is installed. The extra length allows for the bolt to pass through the hose clamp. If the filler kit is not installed, this bolt is not required.



**STEP 12**

Lower the engine and transmission and re-tighten the six mounting nuts which were removed in Step 8.



**Reconnect the wiring harness which was disconnected at the beginning of the installation process. The loom should pass neatly along the back side of the sump, as shown below.**





**Completed Assembly:**

If you have any questions, please email us at  
**[technical@dodsonmotorsport.com](mailto:technical@dodsonmotorsport.com)**